

# FRETWIRE AND FRETTING TOOLS

## Dunlop Fretwire

All measurements are in millimetres. Prices are for a 610mm (24") length

No.	Gauge	A	B	C	D
9770	Extra heavy	0.51	1.37	2.92	1.27
9771	Heavy	0.51	1.88	0.91	2.69
9772	Medium	0.60	2.18	1.10	2.50
9773	Light	0.52	1.40	1.08	1.99
9774	Extra heavy	0.53	1.78	1.47	2.99
9775	Heavy	0.53	1.78	1.40	2.79
9776	Medium	0.53	1.59	1.40	2.29
9777	Light	0.60	1.60	1.00	2.00

Key to Fretwire Measurements

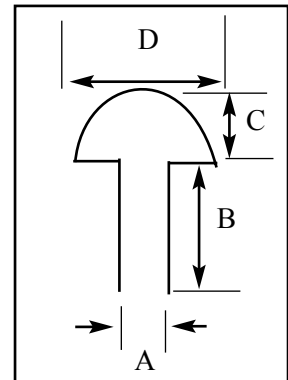

## Other Fretwire

All fretwire is nickel-silver. Prices are for a 5m coil. Measurements may vary by up to 0.1mm

No.	Gauge	Origin	A	B	C	D	Suggested usage
9650	Medium	Korean	0.70	1.40	1.20	2.00	Classical, SC/TC etc.
9661	Medium heavy	Korean	0.65	1.45	1.20	2.30	Folk PB/JB etc.
9662	Heavy	Korean	0.65	2.55	1.15	2.60	LP/SG etc.
9613	Extra light	Japanese	0.50	1.25	0.80	1.15	Mandolin etc.
9614	Medium	Japanese	0.62	2.00	0.95	2.00	Classical, SC/TC etc.
9615	Heavy	Japanese	0.60	1.75	0.80	2.40	Folk PB/JB etc.
9616	Extra heavy	Japanese	0.62	1.80	0.95	2.70	LP/SG etc.
9617	Light	Dutch	0.62	1.15	0.75	1.70	Banjo etc.
9618	Medium	Dutch	0.62	1.40	1.20	2.10	Classical, SC/TC etc.
9619	Heavy	Dutch	0.62	2.30	1.10	2.45	Folk PB/JB etc.
9620	Extra heavy	Dutch	0.62	1.65	1.10	2.90	LP/SG etc.

## Fretting & Other Saws

- 9802A Handiwork microsaw
- 9802D Japanese saw, finest quality, Dozuki Universal 240mm
- 9802K Japanese Kataba Universal, 240mm
- 9802DS Japanese Mini Dozuki, 150mm
- 9815 Bridge pin slot saw
- 9905 Fret tang nipper

